



INSTALLATION INSTRUCTIONS

CARBAHN.COM/INSTRUCTIONS

G87 M2 CARBON FIBER CANARDS

CARBAHN PART #:

CBB02-24-0300



US Based Support

866-558-4314

Sales@CarBahn.com

CarBahn.com

Follow Us: [@CarBahnOfficial](https://twitter.com/CarBahnOfficial)

These instructions assume that the person installing these parts is a **BRAND CERTIFIED MECHANIC** and are **NOT** step by step instructions on how to disassemble and reassemble the car.

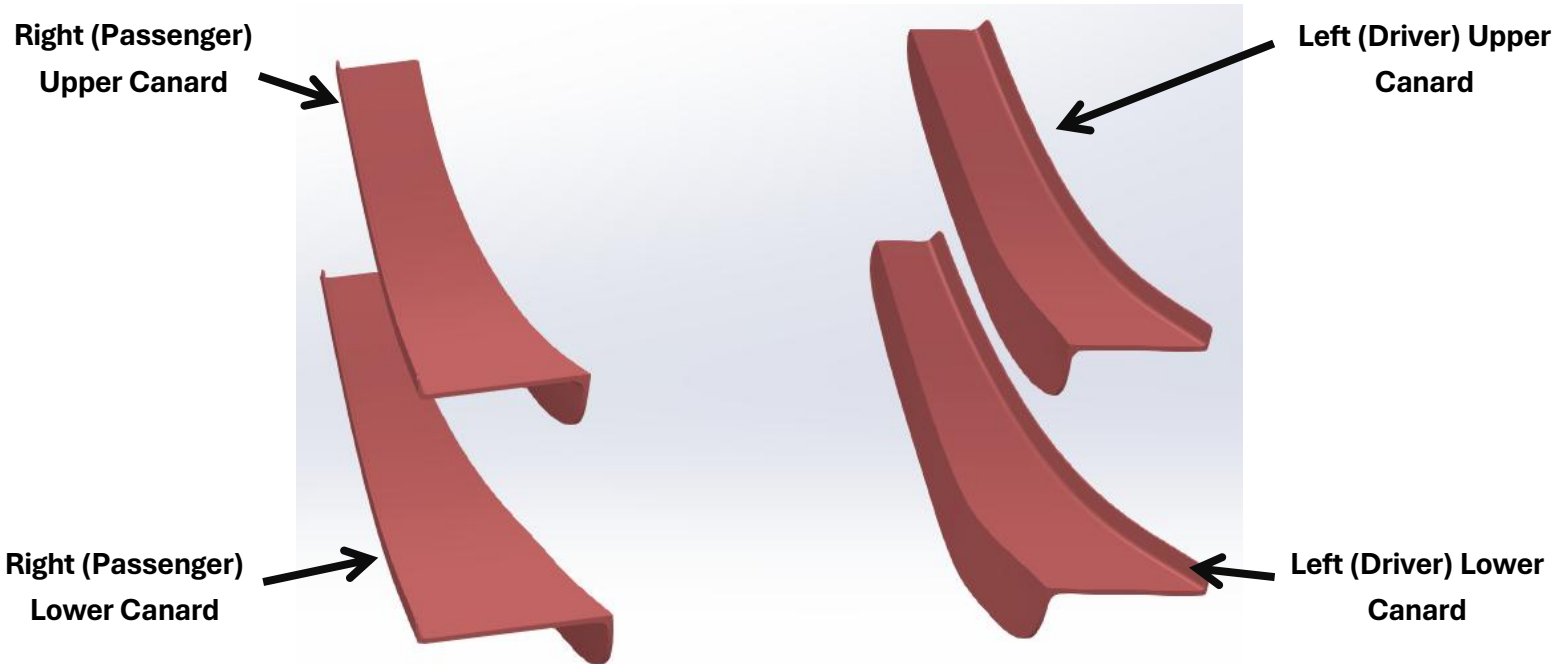

1. You will want to begin by cleaning the surface with a degreaser or rubbing alcohol, a crucial step to ensure proper adhesion.
2. Starting with the driver side, locate the Left (Driver side) Lower canard, the longer one of the two will be your lower canard.

These instructions assume that the person installing these parts is a **BRAND CERTIFIED MECHANIC** and are **NOT** step by step instructions on how to disassemble and reassemble the car.

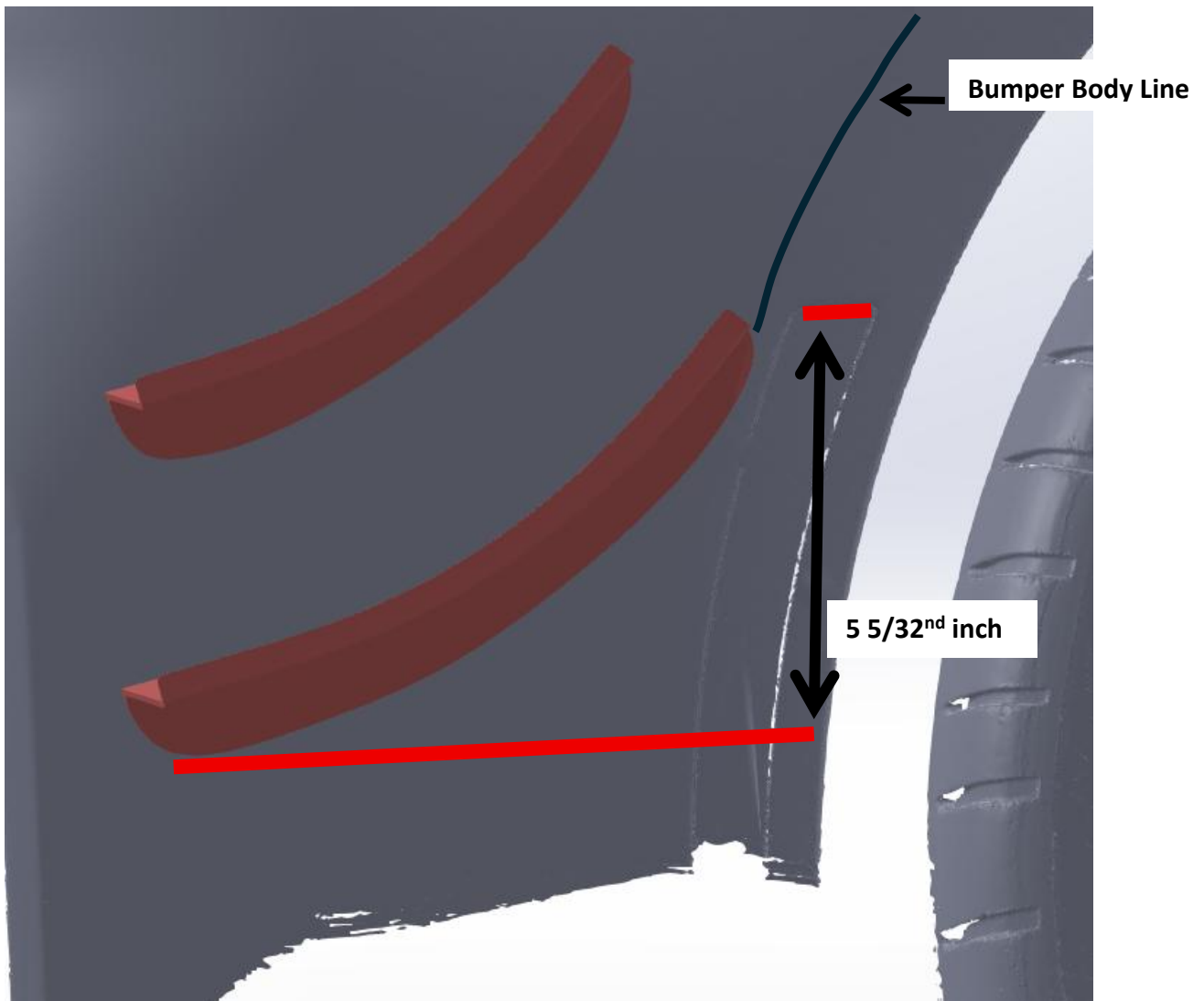

3. The top edge of the lower canard will be in line with the top of the reflector and on the edge of the body line marked above.
4. Next, mark a line that is parallel to the top of the reflector down 5 5/32nd of an inch. This will be your reference for the bottom edge of the lower canard.
5. You can now proceed to install your Left (Driver's side) lower canard.

These instructions assume that the person installing these parts is a **BRAND CERTIFIED MECHANIC** and are **NOT** step by step instructions on how to disassemble and reassemble the car.

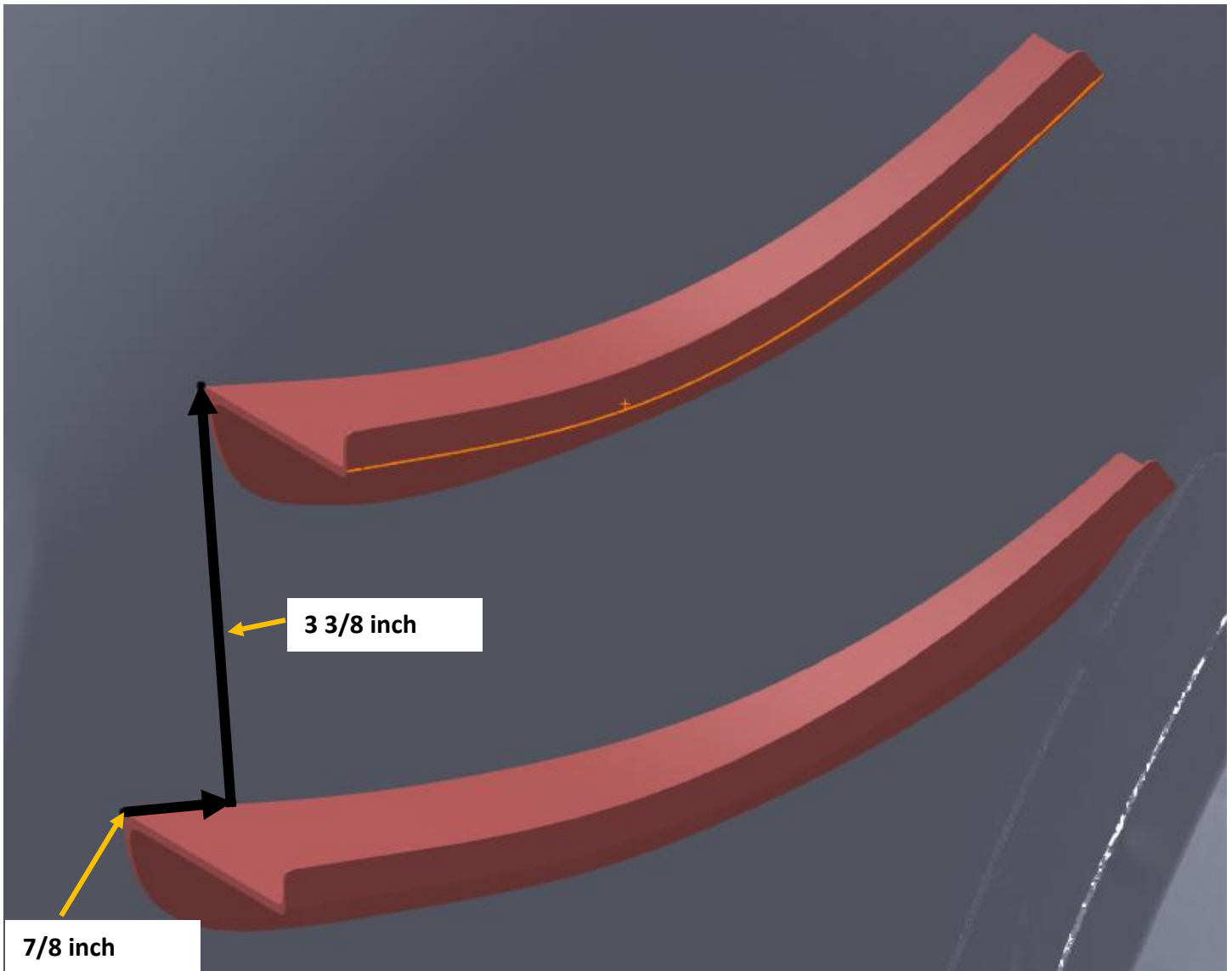

6. Now locate the Left (Driver's side) Upper Canard, you will begin by making your first reference point. From the edge of the lower canard, along the bumper, measure 7/8ths of an inch. From that point go up perpendicularly 3 3/8ths of an inch. This will be where the upper canard edge will be.

These instructions assume that the person installing these parts is a **BRAND CERTIFIED MECHANIC** and are **NOT step by step instructions on how to disassemble and reassemble the car.**

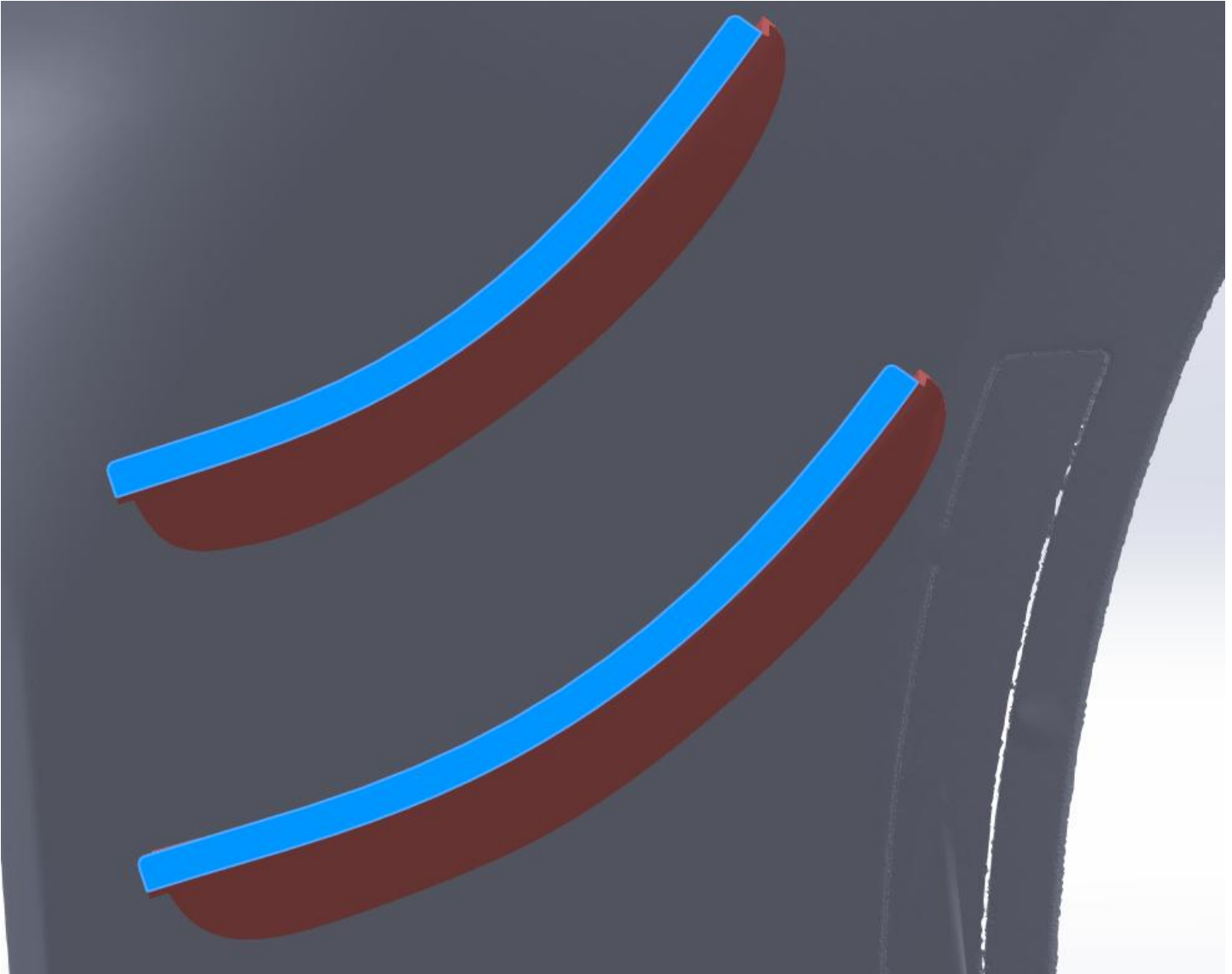

7. With your reference point from the previous step, match the angle of the lower canard.
8. Once you are confident of where it goes, install the upper canard.
9. With the driver's side done, proceed Steps 3-8 on the Right (Passenger Side) of the vehicle. Making a note that the longer canard is the lower canard.